

1. Termination Tool

IMPORTANT - Termination should be completed using a 110 termination tool set on low impact.

2. Incoming Cable Management

Establish the direction of incoming cable prior to termination as this will assist with bend radius management and determine the minimum backbox depth (25mm minimum requirement).

3. Cable Preparation & Termination

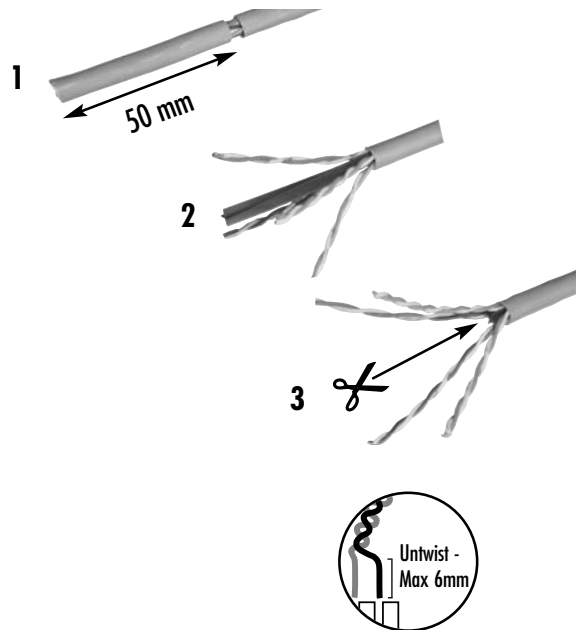

**Molex Premise Networks
Corporate Headquarters**
Tel: 1 866 733 6659
www.molexpn.com

**European
Headquarters**
Tel: 44 (0) 1489 572111
www.molexpn.co.uk

**Pac Rim
Headquarters**
Tel: 61 3 9971 7111
www.molexpn.com.au

**Molex
Incorporated**
Tel: 630 969 4550
www.molex.com

**4. Cable Strain Relief**

Fit cable strain relief stuffer cap ensuring the "U" shape cut-out follows the direction of the incoming cable.

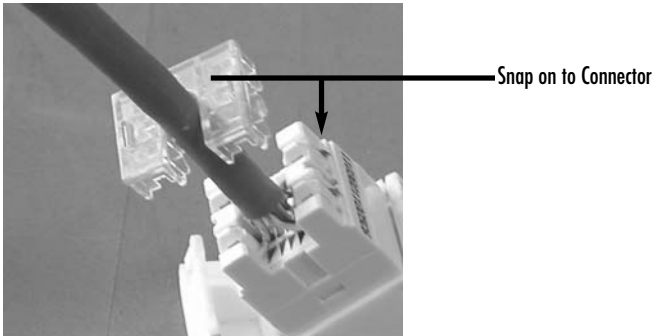
**7. Snap Contura Modules into Place**

Ensure Category 6 bend radius is maintained in backbox.

**5. Wall Plate Installation**

Fit grid-plate to back box or trunking with screws provided.

**6. Snap Contura Wall Plate on to the Grid-Plate****MOLEX PREMISE NETWORKS**

**Molex Premise Networks
Corporate Headquarters**
Tel: 1 866 733 6659
www.molexpn.com

**European
Headquarters**
Tel: 44 (0) 1489 572111
www.molexpn.co.uk

**Pac Rim
Headquarters**
Tel: 61 3 9971 7111
www.molexpn.com.au

**Molex
Incorporated**
Tel: 630 969 4550
www.molex.com