

### PUSH PULL PLUG-CAT6A



#### 1.0 Scope:

This document describes the installation instructions for Push pull jack-Cat6A.

#### 2.0 Product Description.

Push pull jack is shielded jack and D-shaped panel connector, it is front fixing jack to panel with screws.

#### 3.0 Procedures

- **Tools required:** Parallel press tool and Side Cutter.

#### 4.0 Cable preparation and Assembly:

##### 4.1 Slide the boot (1.) and the chuck (2.) onto the cable

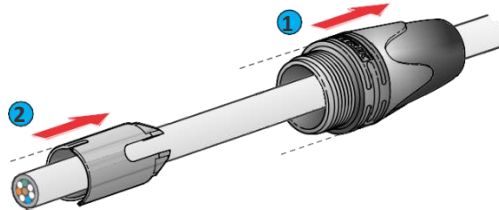

##### 4.2 Prepare the cable as shown and strip the jacket at a length of 35 mm.

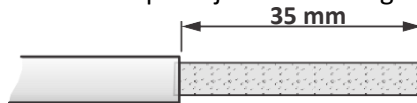

##### 4.1.A S/FTP : Cut off braided shield to approx. 20 mm and fold the shield backwards.

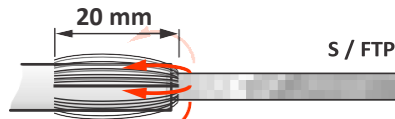

##### 4.1.B U/FTP: Remove the foil of the paired wires and bend back the drain wire for easier handling during assembly. Drain wire to be used for grounding.

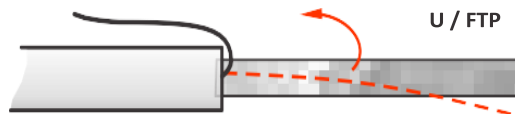

##### 4.1.C SF/ UTP: Cut off braided shield to approx. 20 mm and fold the shield backwards. Cut and remove the Foil screen.

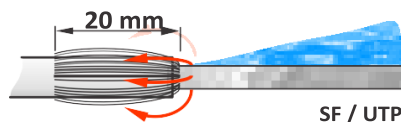

##### 4.3 Remove the pair screening (if existing) to max. 6 mm.

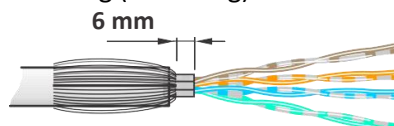

##### 4.4 Presort, untwist, and straighten the wires as shown. Un-straightened wires could potentially harm the IDC.

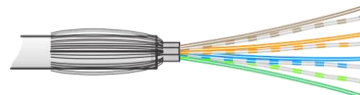

ENGINEERING RECORD NO : 664864	SAP NO : 187000556	Doc No: 187000552	Doc part: AS	REV- A
<a href="http://www.molexces.com">http://www.molexces.com</a>				

**4.5** Insert the wires into the designated position of the wire management as per below wiring scheme, either T568A or T568B.

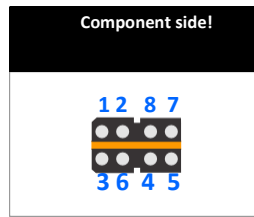
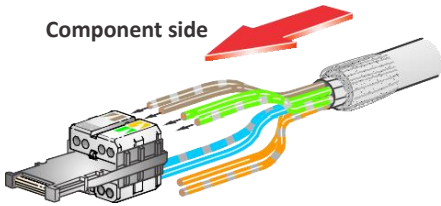

Color code		RJ 45 PIN No.
T568A	T568B	
W - G	W - O	1
G	O	2
W - O	W - G	3
BL	BL	4
W - BL	W - BL	5
O	G	6
W - BR	W - BR	7
BR	BR	8

- 4.6**
1. Use pliers wrench to press the wire management together.
  2. Cut all wires with a wire cutter, allow wires to protrude max. 0.5 mm.
  3. Remove the assembly guidance.

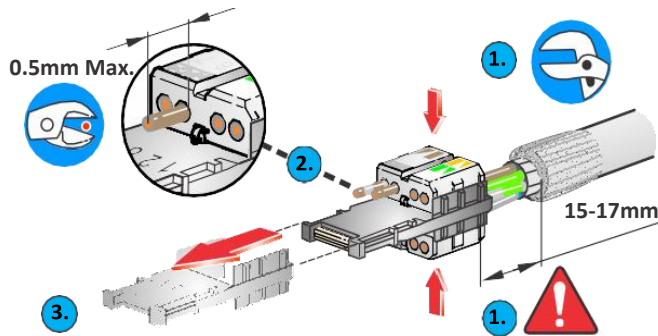

**Attention: Distance between the cable jacket and the wire management shall not exceed 15 - 17 mm.**

**4.7** Position the ground-shells over the wires as shown.

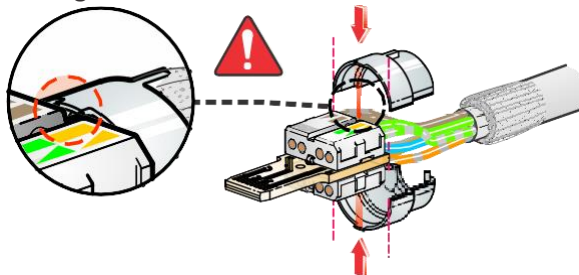

**Attention: Align the coding nibs of the ground shells to the grooves in between the wire pairs in the wire management.**

- 4.8**
- A. Put the cable-shield over the ground shell and distribute the shield wires circumferentially.
  - B. Put the drain wire over the ground shell and wrap the drain wire circumferentially.

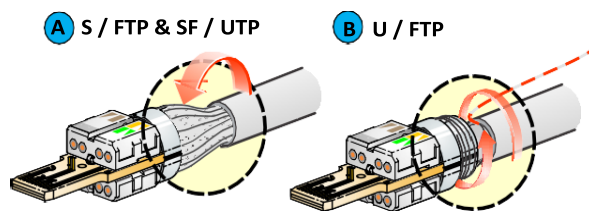

**4.9** Slide the chuck over the cable-shield / drain wire and the ground shell towards the end-position.

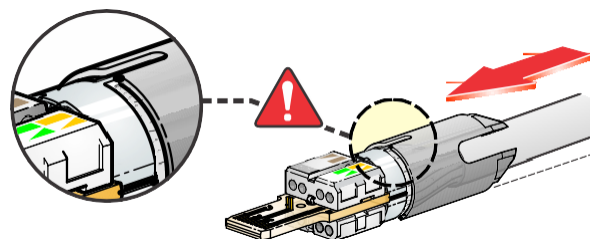

**Attention: Align the slots of the chuck to the ribs of the ground shell.**

**4.10** Slide the pre-assembled cable (step G) into the housing, Slide the gasket onto the chuck.

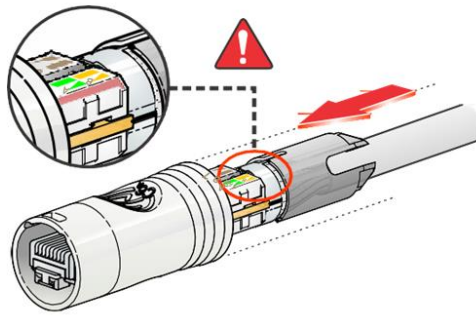

**Attention:** Align the side of the wire management with wire numbers 1/2, 8/7 to the side of the housing that has the Neutrik logo and the slot.

**4.11** Finish the installation by turning the bushing onto the connector

